

500 Series

How to Order

D 5 59 A - 2 M - 10

VARIATION**

- D** Deflector cap
- K** Cryogenic service, special cleaning & testing (stainless steel only)

SEAL MATERIAL & TEMPERATURE RANGE

- 20** Teflon®
520 Series**: -100° F to +400° F (-73°C to +204°C)
K520 Series**: -320° F to +165° F (-196°C to +74°C)
- 24** Silicone*, -70° F to +450° F (-57°C to +232°C)
- 32** Viton®, -20° F to +400° F (-29°C to +204°C)
- 33** Neoprene, -40° F to +300° F (-40°C to +149°C)
- 59** Buna N, -65° F to +275° F (-54°C to +135°C)
- 62** Ethylene propylene, -65° F to +300° F (-54°C to +149°C)
- 80** Teflon®, -320° F to +165° F (-196°C to +74°C)

CRACKING PRESSURE
Specify cracking pressure setting in psig (0.5 – 150 psig)

CONNECTION
See "Valve Size & Type Codes" table, below

VALVE SIZE
Pipe sizes in 1/8" increments (see "Valve Size & Type Codes" table, below)

BODY MATERIAL

- A** Aluminum
- B** Brass
- T** 303 stainless steel†
- T1** 316 stainless steel

'D' Variation: Prefixed part number is supplied with a cap which diverts high pressure blasts from personnel and instruments, and serves as a rain and dust shield.

* Not available over 74.9 psi (5 bar)

** 520 Series: Teflon® o-ring

K520 Series: Polished Teflon® o-ring, cryogenic testing and serialization

580 Series: Polished Teflon® o-ring

† Not available for PED applications

†† Blank if not required

Valve Size & Codes

Size	Pipe Thread Male	Pipe Thread Male/Female	British Pipe Thread Male/Female	British Taper Pipe Male
1/8"	-1M	—	—	-1S
1/4"	-2M	-2MP	-2SX	-2S
3/8"	-3M	-3MP	-3SX	-3S
1/2"	-4M	-4MP	-4SX	-4S
3/4"	-6M	-6MP	-6SX	-6S
1"	-8M	-8MP	—	-8S
1 1/4"	—	-10MP	—	—

To specify PED certification, add PED prefix to the part number.

Please consult your Circle Seal Controls distributor or our factory for information on special connections, operating pressures and temperature ranges.

Repair Kits

In normal service, the only part(s) which may require replacement is(are) the seal(s). A repair kit may be ordered by placing a "K/" in front of the complete part number (i.e. K/559A-2M-10).

Dimensions (Inches)

Popoff

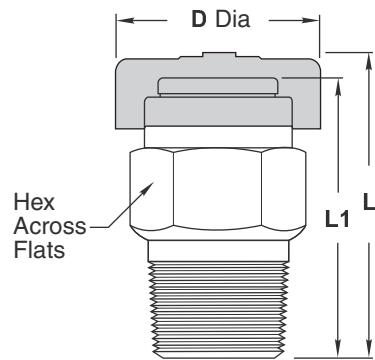

Pipe Size, Male	L	L1	Hex	D Dia. Max.
1/8"	1.14	0.98	1/2	0.63
1/4"	1.38	1.20	5/8	0.90
3/8"	1.43	1.25	3/4	1.21
1/2"	1.98	1.74	1	1.45
3/4"	2.31	2.07	1 1/8	1.45
1"	3.16	2.86	1 1/2	1.89

Inline

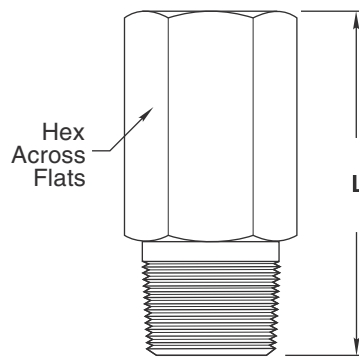

Pipe Size, Male & Female	L	Hex
1/4"	1.62	3/4
3/8"	2.08	7/8
1/2"	2.34	1
3/4"	2.72	1 1/4
1"	3.62	1 1/2
1 1/4"	4.67	1 7/8

For Your Safety

It is solely the responsibility of the system designer and user to select products suitable for their specific application requirements and to ensure proper installation, operation, and maintenance of these products. Material compatibility, product ratings and application details should be considered in the selection. Improper selection or use of products described herein can cause personal injury or property damage.

Freon® is a registered trademark of DuPont.

Viton® is a registered trademark of DuPont Dow Elastomers.

Teflon® is a registered trademark of the DuPont Company.